

MB1187

Load Pin

Content of Loadpin Datasheet

Page 1 ... General

Page 2 ... Mounting Situation

Page 3 ... Output Signal & Wiring

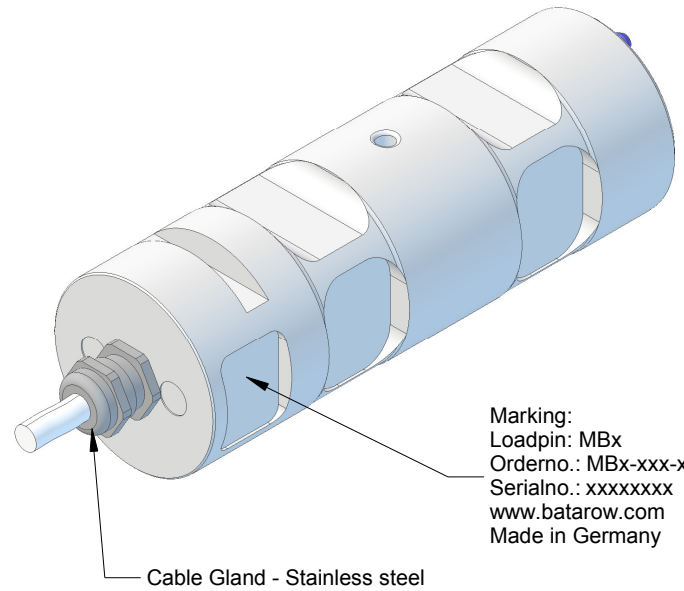
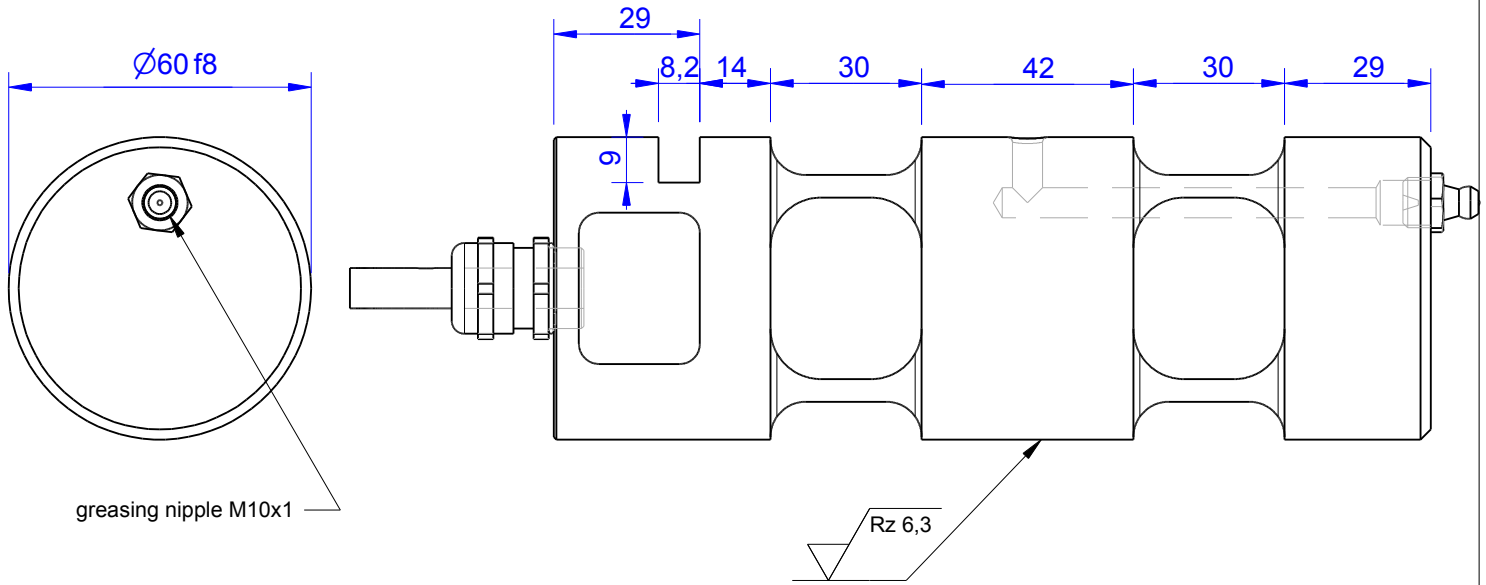

Order-number	Capacity (F.S.)	Uncertainty (k=2)	Review
MB1187-20-x-C	20 kN	$\pm 0,10$ kN	C
MB1187-75-x-C*	75 kN	$\pm 0,40$ kN	C
MB1187-100-x-C	100 kN	$\pm 0,50$ kN	C
MB1187-200-x-C	200 kN	$\pm 1,00$ kN	C
MB1187-350-x-C	350 kN	$\pm 1,8$ kN	C

* above showed version
The fixed dimensions don't change at the other capacity.

Specifications:

Dimension / Material		
Material		1.4542
Protection class		IP 66
Hardness (load area)	HRC	40..45
Mechanical Data		
Safe Load Limit	% of F.S.	150
Breaking Load	% of F.S.	300
Precision		
Nonlinearity	% of F.S.	$\pm 0,5$
Nonrepeatability	% of F.S.	$\pm 0,25$
Hysteresis	% of F.S.	$\pm 0,2$
Temp. Shift Zero	% of F.S./K.	$\pm 0,05$
Temp. Shift Span	% of F.S./K.	$\pm 0,05$
Temperature		
Compensated Temp.	°C	-10...+60
Operating Temp.	°C	-20...+70

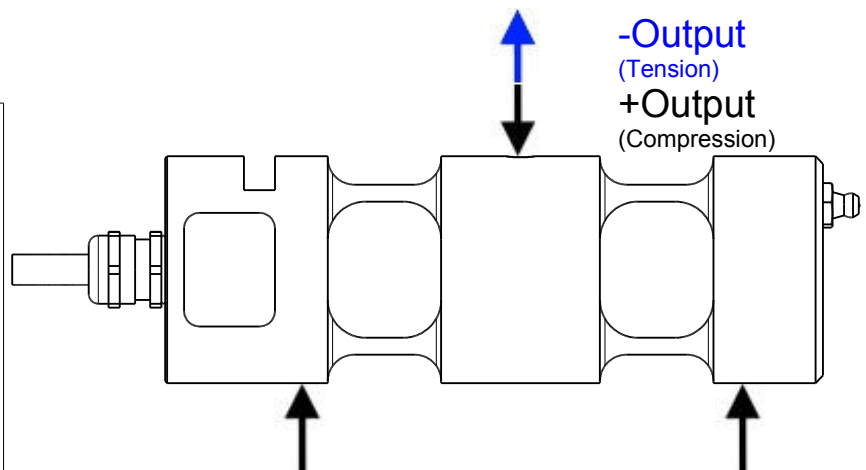

Mounting Situation

MB1187 Review: C

Bore fit of mounting situation: H7

Configuration

possible mounting situation / customer mounting could vary

(Please describe mounting situation with Vs, Ws, Xs, Ys and Zs for best possible calibration)

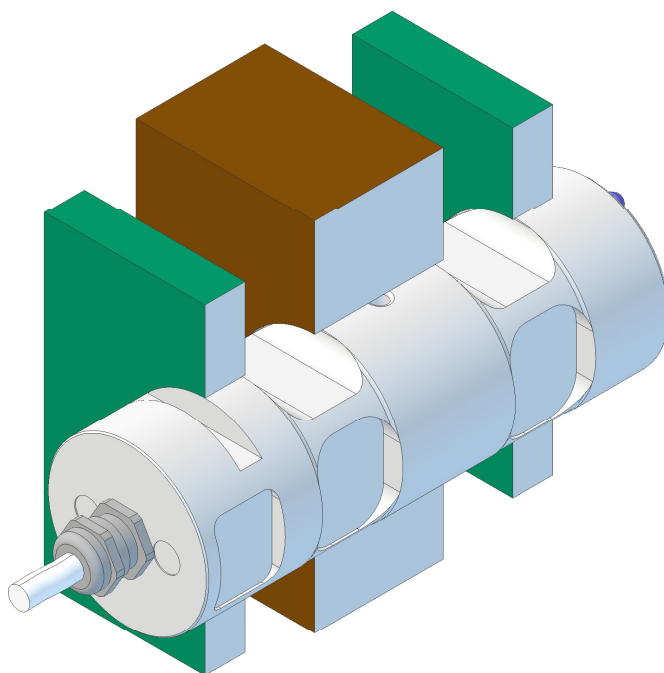
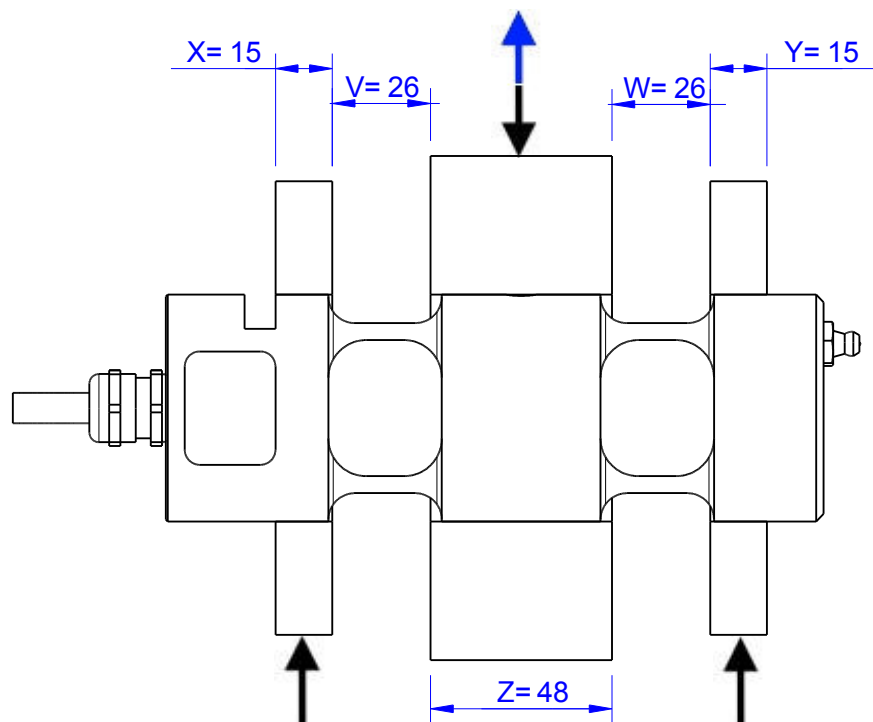

Batarow
Made in Germany

Batarow Sensorik GmbH
Pappelweg 16
18276 Lüssow OT Karow

Mail: info@batarow.com
Phone: +49 (0) 3843-855555
Fax : +49 (0) 3843-218842

Internet:
www.batarow.com

Output Signal & Wiring

MB1187 Review: C

Analog & Switch Output 4..20mA (I20)*

Configuration Master

Electrical Data I20		
Output @ 0kN	mA	4
Output @ F.S.	mA	20
Supply Voltage	V	11..30
Current Consumption	mA	35 (@ 24V)
Bandwidth	Hz	5000
Switching Output		n.c.
max. Switching current	mA	n.c.

Attention:

The difference between Master and Slave is, that the direction of the output signal has an opposite direction.

Configuration Slave

Electrical Data I20		
Output @ 0kN	mA	20
Output @ F.S.	mA	4
Supply Voltage	V	11..30
Current Consumption	mA	35 (@ 24V)
Bandwidth	Hz	5000
Switching Output		n.c.
max. Switching current	mA	n.c.

Wiringcode: WC515			
integrated Amplifier GSV			
Cabeling: 3m 3x2x0,25 PUR			
Master		Slave	
Supply (+)	brown	Supply (+)	yellow
Ground (-)	white	Ground (-)	grey
Output	green	Output	pink

Ordernumber Add-On:

MBxxx-x-I20-x

Attention: Nipple orientation of connector is not fixed. In case of 90° connector - it is necessary to set by customer.

*Attention: With this output configuration is no negative signal (Tension) possible. Please ask our engineering for 4..12..20mA; 1..5..9V or ±10V versions.

Batarow
Made in Germany

Batarow Sensorik GmbH
Pappelweg 16
18276 Lüssow OT Karow

Mail: info@batarow.com
Phone: +49 (0) 3843-855555
Fax : +49 (0) 3843-218842

Internet:
www.batarow.com

Performance Level

MB1187 Review: C

1. Identification:

ISO 13849-1: 2008 Category 1 PL c

2. Classification:

Used standard: DIN EN ISO 13849-1: 2008

Performance Level: Plc

Category: 1

Diagnostic coverage: Low

MTTFd-value: 70,5 years (for each channel of the redundant loadpin)

3. Limits for the operation:

All technical information from datasheet have to be considered.

Deviations lead to loss of safety functions: Attention

Only use the loadpin within the temperature limits of -20°C to $+70^{\circ}\text{C}$

Use the right range of supply voltage

Protect the loadpin of mechanical overload

4. Lifetime

The calculations are based on a lifetime of 20 years in continuous operation with a maximum duty cycles of from 5,000 cycles per year.

5. Error display:

The error display is performed by the undershoot and overshoot of the signal.

Current output:

Error 1: the output current is less 3.5mA

Error 2: the output current is greater 20.5mA